

# B200001

# PH



- ▶ 主要技术特性 (Main Specifications)
- ▶ 适用导线规格 (Applicable wire) : AWG32#~24#
- ▶ 适用基板厚度 (Applicable PC board thickness) : 0.8mm~1.6mm
- ▶ 温度范围 (Temperature range) : -25°C~+85°C
- ▶ 额定电压 (Voltage rating) : 250V AC, DC
- ▶ 额定电流 (Current rating) : 2A AC, DC
- ▶ 接触电阻 (Contact resistance) :  $\leq 0.02 \Omega$
- ▶ 绝缘电阻 (Insulation resistance) :  $\geq 1000M \Omega$
- ▶ 耐压 (Withstanding voltage) : 800V AC/minute

### 材料及电镀规格 Material and Finish

型号 Type		材料 Material	材料厚度 Material Thickness	电镀规格 Finish
插座 WAFER	塑胶 HOUSING	PA66 UL94V-0	—	N/A
	针 PIN	黄铜 Brass	0.5mm	镀锡 Tin-plated
孔座 HOUSING		PA66 UL94V-0	—	N/A
端子 TERMINAL		锡青铜 Phosphor bronze	0.2mm	镀锡 Tin-plated

### 产品尺寸图 Product size chart

 单位: mm 一般公差:  $\pm 0.20$ 

### TERMINAL

#### B200001-4

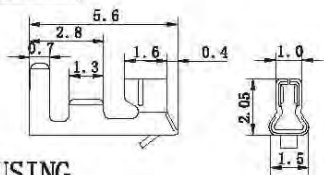

### 安装尺寸 (Mounting measurement)

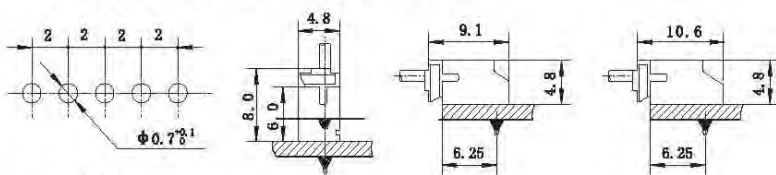

### HOUSING

#### B200001-2

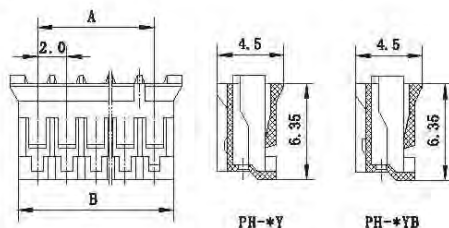

### WAFER

#### B200001-1

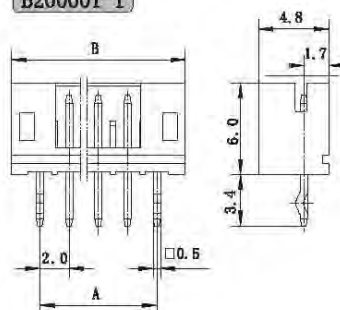

#### B200001-1WD

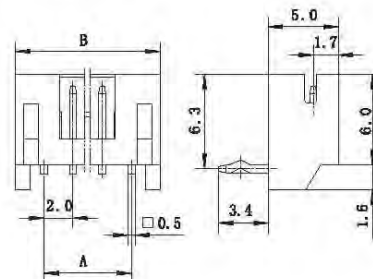

### HOUSING

极数 Circuits	型号 Type		尺寸 (Dimensions) mm		备注型号 P. S. Type	
			A	B		
2	B200001-2-02	B200001-2-02B	2.0	4.6	PH-02Y	PH-02YB
3	B200001-2-03	B200001-2-03B	4.0	6.6	PH-03Y	PH-03YB
4	B200001-2-04	B200001-2-04B	6.0	8.6	PH-04Y	PH-04YB
5	B200001-2-05	B200001-2-05B	8.0	10.6	PH-05Y	PH-05YB
6	B200001-2-06	B200001-2-06B	10.0	12.6	PH-06Y	PH-06YB
7	B200001-2-07	B200001-2-07B	12.0	14.6	PH-07Y	PH-07YB
8	B200001-2-08	B200001-2-08B	14.0	16.6	PH-08Y	PH-08YB
9	B200001-2-09	B200001-2-09B	16.0	18.6	PH-09Y	PH-09YB
10	B200001-2-10	B200001-2-10B	18.0	20.6	PH-10Y	PH-10YB
11	B200001-2-11	B200001-2-11B	20.0	22.6	PH-11Y	PH-11YB
16	B200001-2-16	B200001-2-16B	30.0	32.6	PH-16Y	PH-16YB

# B200001

# PH

## WAFER

极数 Circuits	型号 Type		尺寸(Dimensions)mm		备注型号 P. S. Type	
			A	B		
2	B200001-1-02	B200001-1WD-02	2.0	6.0	PH-02A	PH-02AWD
3	B200001-1-03	B200001-1WD-03	4.0	8.0	PH-03A	PH-03AWD
4	B200001-1-04	B200001-1WD-04	6.0	10.0	PH-04A	PH-04AWD
5	B200001-1-05	B200001-1WD-05	8.0	12.0	PH-05A	PH-05AWD
6	B200001-1-06	B200001-1WD-06	10.0	14.0	PH-06A	PH-06AWD
7	B200001-1-07	B200001-1WD-07	12.0	16.0	PH-07A	PH-07AWD
8	B200001-1-08	B200001-1WD-08	14.0	18.0	PH-08A	PH-08AWD
9	B200001-1-09	B200001-1WD-09	16.0	20.0	PH-09A	PH-09AWD
10	B200001-1-10	B200001-1WD-10	18.0	22.0	PH-10A	PH-10AWD
11	B200001-1-11	B200001-1WD-11	20.0	24.0	PH-11A	PH-11AWD
16	B200001-1-16	B200001-1WD-16	30.0	34.0	PH-16A	PH-16AWD

## WAFER

B200001-1WD-※A

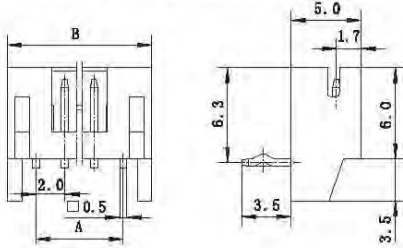

## HOUSING

B200001-5

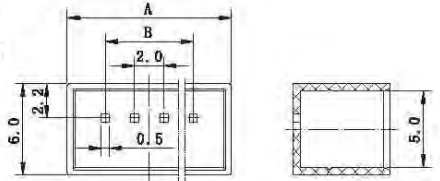

## WAFER

极数 Circuits	型号 Type	尺寸(Dimensions)mm		备注型号 P. S. Type
		A	B	
2	B200001-1WD-02A	2.0	6.0	PH-02AWDL
3	B200001-1WD-03A	4.0	8.0	PH-03AWDL
4	B200001-1WD-04A	6.0	10.0	PH-04AWDL
5	B200001-1WD-05A	8.0	12.0	PH-05AWDL
6	B200001-1WD-06A	10.0	14.0	PH-06AWDL
7	B200001-1WD-07A	12.0	16.0	PH-07AWDL
8	B200001-1WD-08A	14.0	18.0	PH-08AWDL
9	B200001-1WD-09A	16.0	20.0	PH-09AWDL
10	B200001-1WD-10A	18.0	22.0	PH-10AWDL
11	B200001-1WD-11A	20.0	24.0	PH-11AWDL
16	B200001-1WD-16A	30.0	34.0	PH-16AWDL

## HOUSING

极数 Circuits	型号 Type	尺寸(Dimensions)mm		备注型号 P. S. Type
		A	B	
2	B200001-5-02	7.2	2.0	PH-02RST
3	B200001-5-03	9.2	4.0	PH-03RST
4	B200001-5-04	11.2	6.0	PH-04RST
5	B200001-5-05	13.2	8.0	PH-05RST
6	B200001-5-06	15.2	10.0	PH-06RST
7	B200001-5-07	17.2	12.0	PH-07RST
8	B200001-5-08	19.2	14.0	PH-08RST
9	B200001-5-09	21.2	16.0	PH-09RST
10	B200001-5-10	23.2	18.0	PH-10RST
11	B200001-5-11	25.2	20.0	PH-11RST
16	B200001-5-16	35.2	30.0	PH-16RST